

ELECTRICAL NOTES:

ALL OUTDOOR LIGHTING THAT IS MOUNTED TO THE BUILDING IS REQUIRED TO BE HIGH EFFICACY (FLOURESCENT) CONTROLLED BY A STANDARD SWITCH OR IS CONTROLLED BY A MOTION SENSOR WITH INTEGRAL PHOTO CONTROL.

- 1) MIN. BRANCH CIRCUITS SHALL BE INSTALLED PER CEC Art. 210.11 (C)
- 2) AFCI BRANCH CIRCUIT PROTECTION SHALL BE INSTALLED PER CEC Art.210.12
- 3) RECEPTACLES SHALL BE INSTALLED PER CEC Art. 210-52

NEW RECEPTACLE OUTLETS SHALL BE TAMPER RESISTANT.

AT LEAST ONE RECEPTACLE IN THE BATHROOM SHALL BE LOCATED WITHIN 36 INCHES OF THE OUTSIDE EDGE OF EACH BASIN AND ON THE WALL THAT IS ADJACENT TO THE BASIN OR INSTALLED ON THE SIDE OR FACE OF THE BASIN CABINET NOT MORE THAN 12 INCHES BELOW THE COUNTER TOP PER CEC 210.52 (d).

BATHROOM: PROVIDE AT LEAST HIGH EFFICACY LIGHT FIXTURE. ALL OTHER LIGHTING IN THE BATHROOM SHALL BE HIGH EFFICACY OR CONTROLLED BY VACANCY SENSORS. (150(k)(5)).

GARAGE, LAUNDRY AND UTILITY ROOMS: ALL LIGHTING SHALL BE HIGH EFFICACY AND CONTROLLED BY VACANCY SENSORS. (150(k)(6)).

EXTERIOR RECEPTACLES SHALL HAVE GFCI PROTECTION IN ADDITION TO WEATHERPROOF ENCLOSURES PER CEC 210.8 (a).

LOCATE CARBON MONOXIDE ALARMS AT THE FIRST FLOOR AND SECOND FLOORS, OUTSIDE OF EACH SLEEPING AREA. THESE SHALL BE LISTED PRODUCTS AND INSTALLED PER THE MANUFACTURER'S LISTING. (CRC R315.3, CBC420.4)

A 20 AMP DEDICATED CIRCUIT IS REQUIRED TO SERVE THE REQUIRED BATH OUTLETS. THIS CIRCUIT CANNOT SUPPLY ANY OTHER RECEPTACLES, LIGHTS, FANS, ETC. (Exceptions: where the circuit supplies a single bathroom, outlets for the other equipment within the same bathroom shall be permitted to be supplied). CEC 210.11(C)(3) AND 210.52(D).

ALL NEW BATHROOM RECEPTACLES SHALL BE GFCI PROTECTED. CEC Article 210.8

WHERE RECESSED LUMINARIES COME IN CONTACT WITH INSULATION AN '1C' RATED, ELECTRONIC BALLAST AND AIRTIGHT (AT) ARE REQUIRED. CEC 150.0(k)(8)

PROVIDE AN EXHAUST FAN IN EACH (N) BATHROOM. BATHROOM EXHAUST FANS SHALL BE 'ENERGYSTAR' COMPLIANT, MINIMUM 50 CFM FOR INTERMITTENT VENTILATION, AND EQUIPPED WITH A HUMIDISTAT AND HUMIDITY CONTROL PER 'CALGREEN' SECTION 4.506.1.

FURNISHING AND EQUIPMENT

1. INSTALL ALL PLUMBING FIXTURES PER CODE
2. MEN- WATER CLOSETS, LAVATORIES, URINALS, SOAP DISPENSERS & DISPOSAL UNITS, PAPER HOLDERS, GRAB BARS, MIRRORS, COAT HOOKS AND PARTITIONS.
3. WOMEN- SAME AS MEN, MINUS URINALS, PLUS SANITARY NAPKIN DISPENSER & DISPOSAL UNITS.
4. PROVIDE LEVER HANDLE CONTROLS FOR WATER FAUCETS AT LAVATORY SINKS.
5. FINISH FLOOR SHALL BE 12"x12" NON-SKID CERAMIC TILE
6. FINISH WALLS TO 4 FEET HIGH WITH 12"x12" CERAMIC TILE WITH FINISHED CAP.
7. PROVIDE WATER-RESISTANT GYPSUM BOARD CEILING & WALLS WITH SMOOTH FINISHED WALLS.
8. PROVIDE (1) COAT LATEX PRIMER WITH (2) COATS OF SEMI-GLOSS LATEX ON WALLS & CEILINGS.
9. PROVIDE (1) COAT LATEX PRIMER WITH (2) COATS OF SEMI-GLOSS LATEX ON ANY WOOD TRIM.
10. PROVIDE (2) 36" VANITIES W/ INTEGRAL TOP. LOWES MODEL# C14136A-PS
11. PROVIDE (2) FAUCETS MOEN OXBY BRUSHED NICKEL 2-HANDLE. MODEL #B466OSRN.
12. PROVIDE (2) AQUAPOWER POINT OF USE ELECTRIC WATER HEATERS. MODEL# AQM 2-1.

MECHANICAL NOTES:

NOTE: A MECHANICAL EXHAUST FAN WHICH EXHAUSTS DIRECTLY FROM THE BATHROOM MUST BE INSTALLED. FANS MUST BE ENERGY STAR COMPLIANT AND BE DUCTED TO TERMINATE OUTSIDE THE BUILDING. UNLESS FUNCTIONING AS A COMPONENT OF A WHOLE HOUSE VENTILATION SYSTEM, FANS MUST BE CONTROLLED BY A HUMIDSTAT WHICH SHALL BE READILY ACCESSIBLE. HUMIDSTAT CONTROLS SHALL BE CAPABLE OF ADJUSTMENT BETWEEN A RELATIVE HUMIDITY RANGE OF 50 TO 80 PERCENT. A 4" DIA. SMOOTH EXHAUST DUCT SHALL BE INSTALLED WITH A MAX. OF (3) 90 DEGREE ELBOWS.

ALL ENVIRONMENTAL AIR DUCTS SHALL BE A MINIMUM OF 3 FEET FRC OPENINGS INTO THE BUILDING (i.e., dryers, bath and utility fans, etc. must be away from doors, windows, opening skylights or attic vents). CMC 504.5

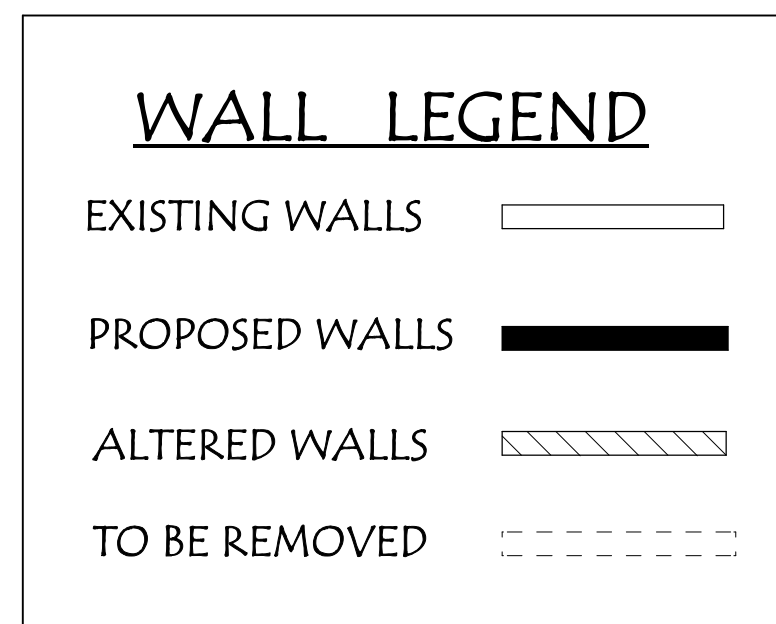

ELECTRICAL SYMBOLS LIST

[Symbol]	110V DUPLEX OUTLET
[Symbol]	220V OUTLET
[Symbol]	110V DUPLEX OUTLET W/ GFI
[Symbol]	110V DUPLEX OUTLET W/ GFI & WATERPROOF COVER
[Symbol]	GAS OUTLET
[Symbol]	PENDANT
[Symbol]	CEILING MNT. INCANDESCENT FIXTURE
[Symbol]	CEILING FLUORESCENT FIXTURE
[Symbol]	RECESSED FLUORESCENT LIGHT
[Symbol]	CEILING FLUORESCENT
[Symbol]	SINGLE POLE SWITCH
[Symbol]	DOUBLE POLE SWITCH
[Symbol]	4" RECESSED LED CAN LIGHT
[Symbol]	UNDER CABINET / FLUORESCENT LIGHTING
[Symbol]	APPROVED SMOKE DETECTOR
[Symbol]	LED CEILING FIXTURE
[Symbol]	HOSE BIBB
[Symbol]	T.V. JACK (CABLE)
[Symbol]	HEAT REGISTER
[Symbol]	COLD AIR RETURN
[Symbol]	EXHAUST FAN
[Symbol]	PHONE JACK
[Symbol]	BELOW COUNTER HEAT REGISTER
[Symbol]	DOOR BELL
[Symbol]	CEILING FAN
[Symbol]	TRACK LIGHTING
[Symbol]	CARBON MONOXIDE ALARM

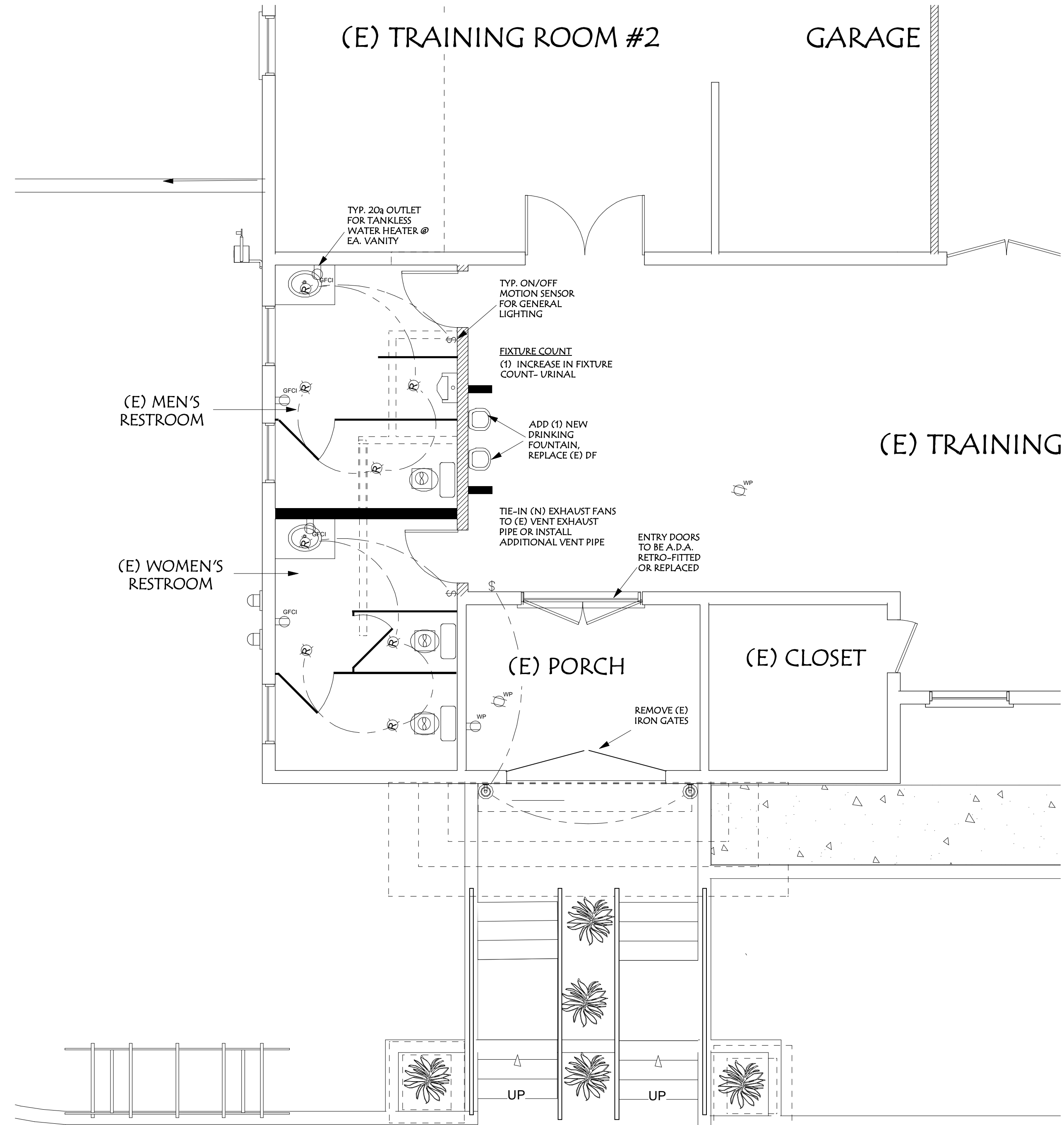

A.D.A.RESTROOM REMODEL/
MECHANICAL & ELECTRICAL PLAN SCALE 1/4" = 1'-0"

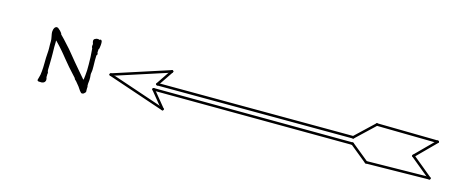

BOULDER CREEK FIRE STATION #1

13230 CENTRAL AVENUE
BOULDER CREEK, CA 95006

PROPOSED REMODEL TO THE:

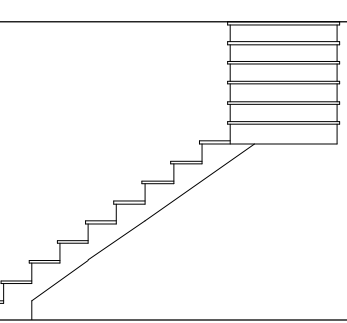

SHEET NUMBER

A-3